

# POWERMAX® COMMERCIAL HEATER

MANUFACTURED PRIOR TO JULY 2006 - REPLACEMENT PARTS

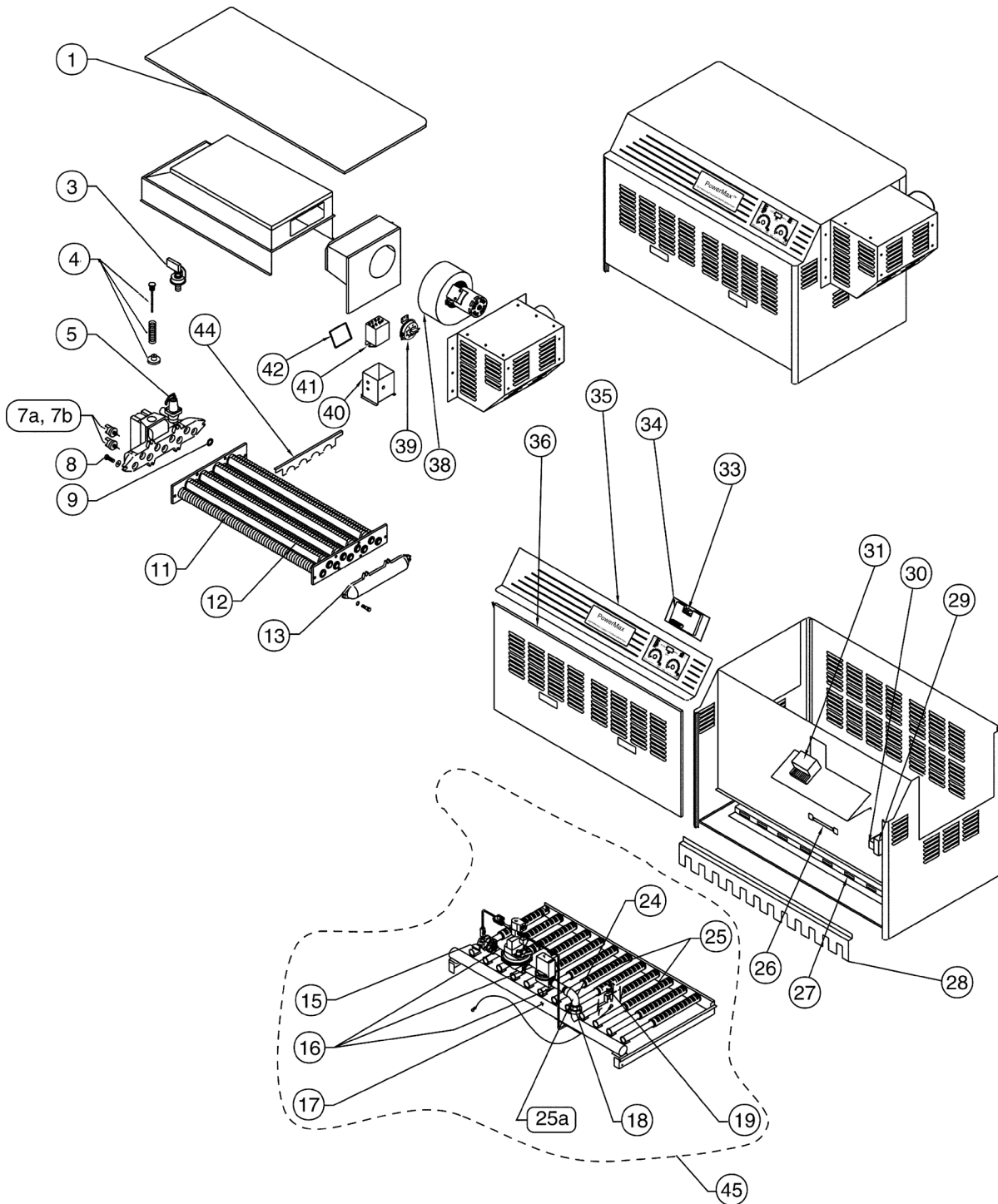

## POWERMAX® COMMERCIAL HEATER (CONT'D)

MANUFACTURED PRIOR TO JULY 2006 - REPLACEMENT PARTS



Item	Part No.	Description	US List	Can. List
POWERMAX® COMMERCIAL HEATER				
1	471310	Top cover (Model 900)	CALL	CALL
3	470190	Pressure switch	112.31	115.68
4	470747	Flow valve assembly (Model 525)	77.47	79.79
4	471114	Flow valve assembly (Model 750)	98.64	101.60
4	471115	Flow valve assembly (Model 900)	77.47	79.79
5	470768	Pressure relief valve	423.40	436.10
7a	071017	Hi-limit switch, 150° shut-off	42.21	43.48
7b	471175	Hi-limit switch, 135° shut-off	66.85	68.86
8	470966	Bolts	23.36	24.06
9	470742	Rubber seal	5.24	5.40
10	470979	Combustion chamber (Model 900)	CALL	CALL
11	470735	Heat Exchanger Assembly (Model 525)	4,059.21	4,180.99
11	470736	Heat exchanger assembly (Model 750)	3,799.82	3,913.81
11	470737	Heat exchanger assembly (Model 900)	CALL	CALL
12	470645	Baffle (Model 525)	24.55	25.29
12	470646	Baffle (Model 750)	22.88	23.57
13	470646	Baffle (Model 900)	22.88	23.57
14	470745	Return header	389.96	401.66
14	470772	Pilot manual valve (Model 900)	CALL	CALL
15	470773	Main shut-off valve	CALL	CALL
17	470653	Manifold (Model 750)	323.47	333.17
19	471204	Pilot Q3451B1178 natural	109.21	112.49
19	471205	Pilot Q3451B1236 propane	109.21	112.49
20	470771	Pilot regulator (Model 900)	116.54	120.04
21	470770	Pilot valve (Model 900)	302.02	311.08
22	470688	Gas valve solenoid 900 (Model 900)	CALL	CALL
22	470688	Gas valve natural (Model 525 & 750)	CALL	CALL
22	470892	Gas valve propane (Model 525 & 750)	CALL	CALL

Item	Part No.	Description	US List	Can. List
23	470687	Gas valve diaphragm natural (Model 900)	862.56	888.44
25	471537	Burner alternate comm	111.26	114.60
25a	471545	Burner w/ pilot bracket (Model 525)	CALL	CALL
26	075173	Thermal cut-off	19.65	20.24
28	470792	Retainer shield (Model 525)	41.54	42.79
28	470794	Retainer shield (Model 900)	CALL	CALL
29	471426	Junction box	36.22	37.31
30	471571	Transformer	78.98	81.35
31	073584	Module IID S8600F natural	304.49	313.62
31	073585	Module IID S8600H propane	314.48	323.91
33	470186	Rocker switch	11.56	11.91
34	470179	Thermostat board	202.59	208.67
35	470753	Control panel (Model 525)	497.16	512.07
35	470754	Control panel (Model 750)	610.13	628.43
35	470755	Control panel (Model 900)	625.30	644.06
38	471313	Blower (Model 525)	986.49	1,016.08
38	471314	Blower (Model 750 & 900)	1,205.64	1,241.81
39	471428	Air pressure switch	70.23	72.34
40	470331	Blower control box	52.15	53.71
41	470010	Relay	50.98	52.51
44	470799	Baffles hold down	26.31	27.10
45	470648	Burner tray assembly natural (Model 525)	CALL	CALL
45	470649	Burner tray assembly natural (Model 750)	CALL	CALL
45	470650	Burner tray assembly natural (Model 900)	CALL	CALL
45	470669	Burner tray assembly propane (Model 750)	CALL	CALL
NOT SHOWN				
	470180	Thermistor (probe) complete	42.25	43.52
	470181	Stem, thermostat control	5.08	5.23
	470184	Knob, thermostat	11.80	12.15